



MACHINE TAPS - Straight flutes

For blind holes

National pipe thread, taper 1:16 - ASME/ANSI B1.20.1

TAP DIMENSIONS

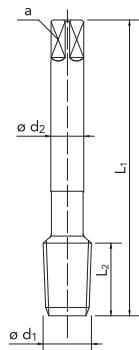

APPLICATION RANGE - CUTTING SPEED m/min

ISO	MG	A6 B BRIGHT			
P	P.2	• 10-15			
	P.3	• 10-12			
	P.4	• 8-10			
K	K.2	• 10-12			

TOOL CODE

A6 B
BRIGHT



Tolerance



Chamfer form



Hole type



Direction of cut



Through coolant

NPT	P [T.P.I.]	Ød1 [mm]	L1 js 16 [mm]	L2 [mm]	L3 [mm]	Ød2 h9 [mm]	a h12 [mm]	z	z [mm]	
1/16"	27	7,938	63	12	-	6	4,9	4	6,15 (°)	•
1/8"	27	10,287	63	12	-	7	5,5	4	8,5 (°)	•
1/4"	18	13,716	63	18	-	11	9	4	11 (°)	•
3/8"	18	17,145	70	18	-	12	9	4	14,5 (°)	•
1/2"	14	21,336	80	23	-	16	12	4	17,85 (°)	•
3/4"	14	26,670	100	24	-	20	16	5	23,2 (°)	•
1"	11 1/2	33,401	110	30	-	25	20	5	29 (°)	•
1 1/4"	11 1/2	42,164	125	32	-	32	24	5	37,8 (°)	•
1 1/2"	11 1/2	48,260	140	32	-	36	29	6	44 (°)	•
2"	11 1/2	60,325	160	34	-	45	35	6	56 (°)	•

• = standard execution
(°) = cylindrical hole (see page 216)